

YAMAHA

FZR600R '95

4JH-SE4

**SERVICE
INFORMATION**

FOREWORD

This Service Information has been prepared to introduce new service and data for the FZR600R '95. For complete service information procedures it is necessary to use this publication together with the following microfiche service manual.

FZR600R '95 SERVICE MANUAL: 4JH-ME4
FZR600R '94 SERVICE INFORMATION: 4JH-SE1
FZR600R '94 SERVICE INFORMATION: 4JH-SE2

FZR600R '95
SERVICE INFORMATION
©1994 by Yamaha Motor Co., Ltd.
1st Edition, September 1994
All rights reserved. Any reprinting or
unauthorized use without the written
permission of Yamaha Motor Co., Ltd.
is expressly prohibited.
Printed in Japan

NOTICE

This manual was written by the Yamaha Motor Company primarily for use by Yamaha dealers and their qualified mechanics. It is not possible to put an entire mechanic's education into one manual, so it is assumed that persons using this book to perform maintenance and repairs on Yamaha motorcycles have a basic understanding of the mechanical concepts and procedures inherent in motorcycle repair technology. Without such knowledge, attempted repairs or service to this model may render it unfit to use and/or unsafe.

Yamaha Motor Company, Ltd. is continually striving to improve all models manufactured by Yamaha. Modifications and significant changes in specifications or procedures will be forwarded to all Authorized Yamaha dealers and will, where applicable, appear in future editions of this manual.

HOW TO USE THIS MANUAL

PARTICULARLY IMPORTANT INFORMATION

This material is distinguished by the following notation.



The Safety Alert Symbol means ATTENTION! BECOME ALERT! YOUR SAFETY IS INVOLVED!

WARNING

Failure to follow WARNING instructions could result in severe injury or death to the motorcycle operator, a bystander, or a person inspecting or repairing the motorcycle.

CAUTION

A CAUTION indicates special precautions that must be taken to avoid damage to the motorcycle.

NOTE:

A NOTE provides key information to make procedures easier or clearer.

MANUAL FORMAT























All of the procedures in this manual are organized in a sequential, step-by-step format. The information has been compiled to provide the mechanic with an easy to read, handy reference that contains comprehensive explanations of all disassembly, repair, and assembly, inspection operations.

In this revised format, the condition of a faulty component will precede an arrow symbol and the course of action required will follow the symbol, e.g.,

- Bearings
Pitting/Damage → Replace.

EXPLODED DIAGRAM

Each chapter provides exploded diagrams before each disassembly section for ease in identifying correct disassembly and assembly procedures.

① GEN INFO 	② SPEC 	
③ INSP ADJ 	④ ENG 	
⑤ COOL 	⑥ CARB 	
⑦ CHAS 	⑧ ELEC 	
⑨ TRBL SHTG ?	⑩ 	
⑪ 	⑫ 	
⑬ 	⑭ 	
⑮ 	⑯ 	
⑰ 	⑱ 	⑲ 
⑳ 	㉑ 	㉒ 
㉓ 	㉔ New	

ILLUSTRATED SYMBOLS

(Refer to the illustration)

Illustrated symbols ① to ⑨ are designed as thumb tabs to indicate the chapter's number and content.

- ① General information
- ② Specifications
- ③ Periodic inspection and adjustment
- ④ Engine
- ⑤ Cooling system
- ⑥ Carburetion
- ⑦ Chassis
- ⑧ Electrical
- ⑨ Troubleshooting

Illustrated symbols ⑩ to ⑯ are used to identify the specifications appearing in the text.

- ⑩ Filling fluid
- ⑪ Lubricant
- ⑫ Special tool
- ⑬ Tightening
- ⑭ Wear limit, clearance
- ⑮ Engine speed
- ⑯ Ω, V, A

Illustrated symbols ⑰ to ㉔ in the exploded diagram indicate grade of lubricant and location of lubrication point.

- ⑰ Apply engine oil
- ⑱ Apply gear oil
- ⑲ Apply molybdenum disulfide oil
- ⑳ Apply wheel bearing grease
- ㉑ Apply lightweight lithium-soap base grease
- ㉒ Apply molybdenum disulfide grease
- ㉓ Apply locking agent (LOCTITE®)
- ㉔ Use new one

CONTENTS

GENERAL INFORMATION	1
MOTORCYCLE IDENTIFICATION	1
VEHICLE IDENTIFICATION NUMBER (For E)	1
FRAME SERIAL NUMBER (Except for E)	1
ENGINE SERIAL NUMBER	1
SPECIFICATIONS	2
GENERAL SPECIFICATIONS	2
MAINTENANCE SPECIFICATIONS	3
CHASSIS	3
CABLE ROUTING	6
EXPLODED DIAGRAM	8
FRONT FORK	8
REAR SHOCK ABSORBER AND SWINGARM	9

MOTORCYCLE IDENTIFICATION

GEN INFO	
---------------------	---

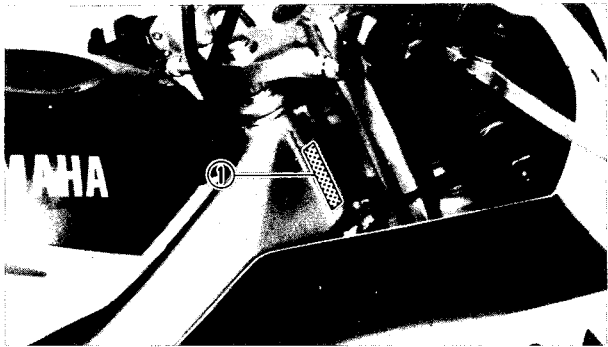

GENERAL INFORMATION

MOTORCYCLE IDENTIFICATION

VEHICLE IDENTIFICATION NUMBER (For E)
The vehicle identification number ① is stamped into the right side of the steering head.

Starting serial number:
JYA4JHS0*SA044101 (for E)

NOTE:
The vehicle identification number is used to identify your motorcycle and may be used to register your motorcycle with the licensing authority in your state.

FRAME SERIAL NUMBER (Except for E)

The frame serial number ① is stamped into the right side of the steering head.

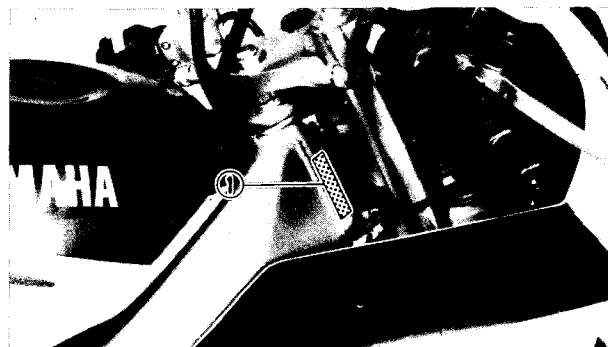

Starting serial number:
4JH-031101 (for D, B, DK, SF, GB, N, NL, F, GR, I and PRT)
4JH-047101 (for D)
4MH-005101 (for D)
4MM-004101 (for CH, A and S)

NOTE:
The first three digits of these numbers are for model identifications; the remaining digits are the unit production number.

ENGINE SERIAL NUMBER

The engine serial number ① is stamped into crankcase.

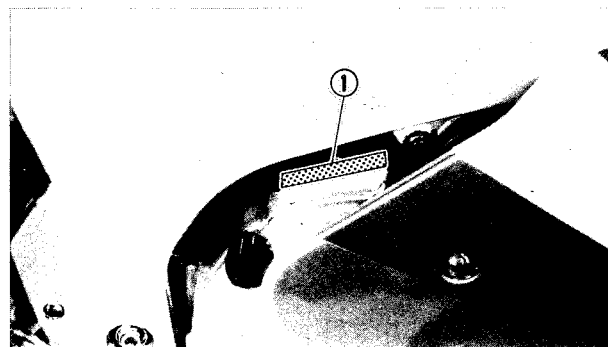

Starting serial number:
4JH-044101 (for E)
4JH-031101 (for D, B, DK, SF, GB, N, NL, F, GR, I and PRT)
4JH-047101 (for D)
4MH-005101 (for D)
4MM-004101 (for CH, A and S)

NOTE:

- The first three digits of these numbers are for model identification; the remaining digits are the unit production number.
- Designs and specifications are subject to change without notice.



SPECIFICATIONS

GENERAL SPECIFICATIONS

Model	FZR600R
Model code:	4JH4 (for D, B, DK, SF, GB, N, NL, F, GR, I and PRT) 4JH5 (for E) 4JH6 (for D) 4MH2 (for D) 4MM2 (for CH, A and S)
Engine starting number:	4JH-031101 (for D, B, DK, SF, GB, N, NL, F, GR, I and PRT) 4JH-044101 (for E) 4JH-047101 (for D) 4MH-005101 (for D) 4MM-004101 (for CH, A and S)
Vehicle identification number:	JYA4JHS0 * SA044101 (for E)
Frame starting number:	4JH-031101 (for D, B, DK, SF, GB, N, NL, F, GR, I and PRT) 4JH-047101 (for D) 4MH-005101 (for D) 4MM-004101 (for CH, A and S)
Basic weight: With oil and full fuel tank	207 kg (456 lb) 209 kg (461 lb) (for CH, A and S)
Tire pressure (cold tire): Maximum load-except motorcycle	173 kg (381 lb) 208 kg (459 lb) (for D) 171 kg (377 lb) (for CH, A and S)
Loading condition A * front	0 ~ 90 kg (0 ~ 198 lb) 225 kPa (2.25 kg/cm ² , 32 psi)
rear	250 kPa (2.5 kg/cm ² , 36 psi)
Loading condition B * front	90 ~ 173 kg (198 ~ 381 lb) 90 ~ 208 kg (198 ~ 459 lb) (for D) 90 ~ 171 kg (198 ~ 377 lb) (for CH, A and S)
rear	250 kPa (2.5 kg/cm ² , 36 psi) 290 kPa (2.9 kg/cm ² , 41 psi)
High-speed riding front	250 kPa (2.5 kg/cm ² , 36 psi)
rear	290 kPa (2.9 kg/cm ² , 41 psi)



MAINTENANCE SPECIFICATIONS
CHASSIS

Model	FZR600R
Front suspension: Front fork travel Fork spring free length <Limit> Collar length Spring rate (K1) Stroke (K1) Optional spring Oil capacity Oil level Oil grade	130 mm (5.12 in) 424.5 mm (16.71 in) 419.5 mm (16.52 in) 150 mm (5.9 in) 8.0 N/mm (0.8 kg/mm, 44.8 lb/in) 0 ~ 130 mm (0.00 ~ 5.12 in) No 431 cm ³ (15.2 Imp oz, 14.6 US oz) 137 mm (5.40 in) Fork oil 10 WT or equivalent
Rear suspension: Shock absorber travel Spring free length Fitting length Spring rate (K1) Stroke (K1) Optional spring Enclosed gas / air pressure (STD)	64 mm (2.52 in) 228 mm (8.98 in) 210 mm (8.27 in) 85.0 N/mm (8.5 kg/mm, 476.0 lb/in) 0 ~ 64 mm (0.00 ~ 2.52 in) No 1,200 kPa (12 kg/cm ² , 171 psi)

MAINTENANCE SPECIFICATIONS

SPEC

Tightening torques

Part to be tightened	Thread size	Tightening torque			Remarks
		Nm	m.kg	ft.lb	
Upper bracket and inner tube	M8	30	3.0	22	See NOTE
Upper bracket and steering shaft	M22	110	11.0	80	
Handle boss and inner tube	M6	13	1.3	9.4	
Handle boss and upper bracket	M6	13	1.3	9.4	
Ring nut (steering shaft)	M25	3	0.3	2.2	
Inner tube and lower bracket	M10	38	3.8	27	
Union bolt (brake hose)	M10	26	2.6	19	
Master cylinder (front brake)	M6	10	1.0	7.2	
Handle boss and handlebar	M8	28	2.8	20	
Engine mounting:					
Mounting bolt (front)	M10	40	4.0	29	
Mounting bolt (rear upper)	M10	48	4.8	35	
Mounting bolt (rear lower)	M10	48	4.8	35	
Pinch bolt (front left)	M10	64	6.4	46	
Exhaust pipe bracket	M10	40	4.0	29	
Frame and rear fender stay	M8	30	3.0	22	
Swingarm pivot shaft	M16	90	9.0	65	
Relay arm and frame	M10	48	4.8	35	
Relay arm and connecting rod	M10	48	4.8	35	
Connecting rod and swingarm	M10	48	4.8	35	
Rear shock absorber and relay arm	M10	40	4.0	29	
Rear shock absorber and bracket	M10	40	4.0	29	
Damping gas compartment	M6	7	0.7	5.1	
Fuel pump and fuel tank	M5	3	0.3	2.2	
Fuel pump and fuel cock	M6	7	0.7	5.1	
Footrest bracket and frame	M8	30	3.0	22	
Rear footrest and frame	M8	30	3.0	22	
Rear master cylinder and footrest bracket	M8	23	2.3	17	
Rear brake reservoir tank	M6	5	0.5	3.6	
Union bolt (rear brake hose)	M10	26	2.6	19	
Sidestand bolt and nut	M10	39	3.9	28	
Sidestand bolt and frame	M10	46	4.6	33	
Front wheel axle	M14	59	5.9	43	
Rear wheel axle	M18	117	11.7	85	
Front brake caliper	M10	35	3.5	25	
Rear brake caliper	M10	35	3.5	25	
Brake disc and wheel	M8	20	2.0	14	
Driven sprocket and clutch hub	M10	60	6.0	43	
Tension bar	M8	30	3.0	22	
Caliper breed screw	M8	6	0.6	4.3	
Pinch bolt (front axle)	M10	40	4.0	29	

MAINTENANCE SPECIFICATIONS

SPEC



NOTE:

1. First, tighten the ring nut approximately 52 Nm (5.2 m • kg, 38 ft • lb) by using the torque wrench, then loosen the ring nut completely.
2. Retighten the ring nut to specification.



CABLE ROUTING

- | | |
|--------------------------------|--------------------------------|
| ① Throttle cable | ⑪ Fan motor lead |
| ② Clutch cable | ⑫ Speedometer cable |
| ③ Handlebar switch lead (left) | ⑬ Headlight lead |
| ④ Clamp | ⑭ Meter light lead |
| ⑤ Main switch lead | ⑮ Ground lead |
| ⑥ Fuel reserve switch lead | ⑯ Reservoir tank breather hose |
| ⑦ Vacuum hose (#4) | ⑰ Roll over hose |
| ⑧ Starter motor lead | ⑱ Fuel tank breather hose |
| ⑨ Sidestand switch lead | |
| ⑩ Starter cable | |

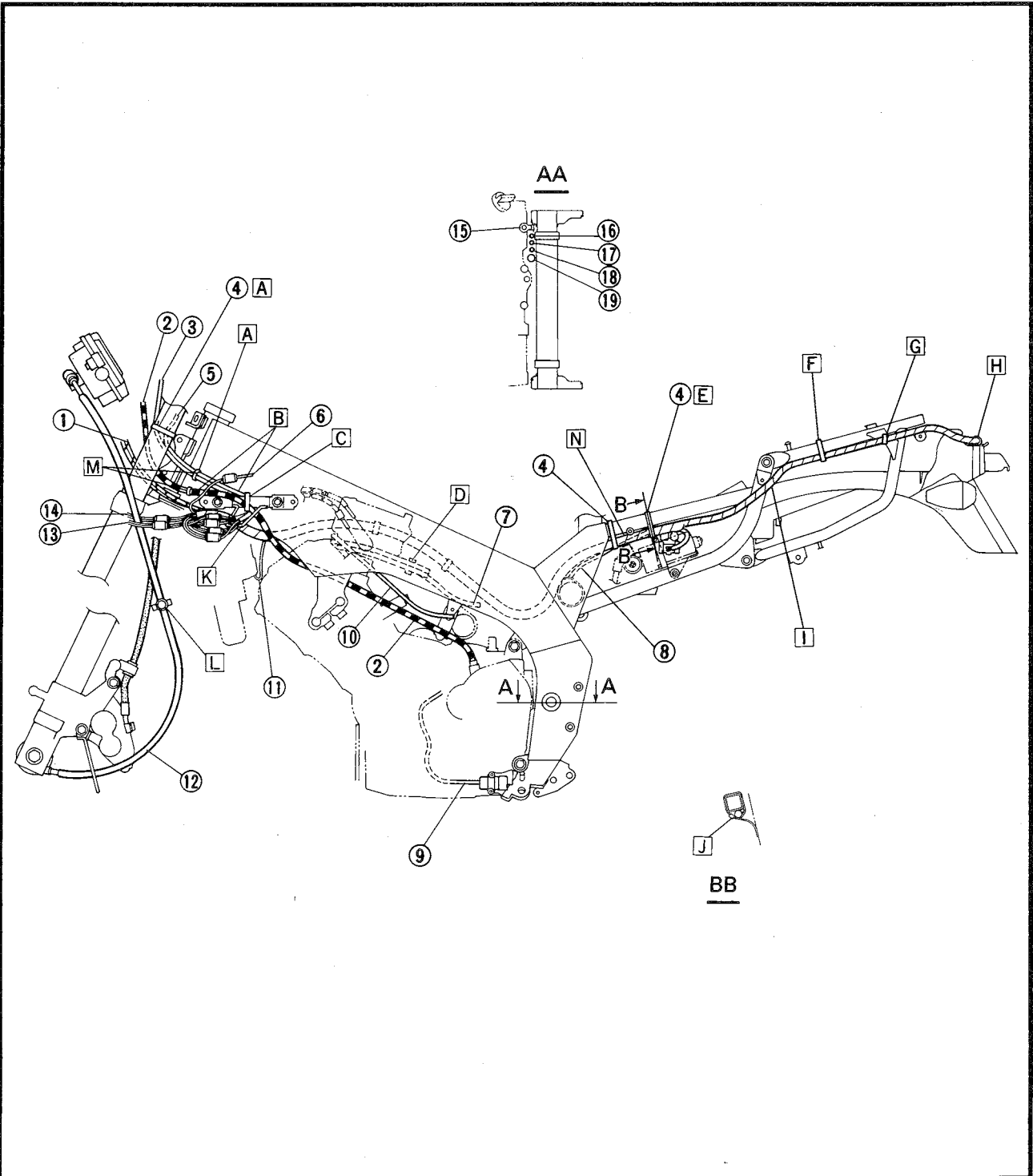

CABLE ROUTING

SPEC



- A** Clamp the main switch lead and handlebar switch lead (left).
- B** Pass the clutch cable along the outside of the bracket and the main switch lead along the inside of the bracket.
- C** Clamp the main switch lead, handlebar switch lead (left) and clutch cable to the bracket.
- D** Clamp the vacuum hose plug onto the inside of the frame and plug hoses #1 ~ #3.
- E** Clamp the main harness and starter motor lead behind the side cover installation screw.
- F** Place the end of the clamp downward.
- G** Insert the clamp into the hole in the rear flame.

- H** Insert the clamp into the seat lock stay.
- I** Pass the main harness to the inside of the rear fender from the outside of the frame.
- J** Place the ends of the clamp on the battery box with the wire along the bottom of the frame.
- K** Pass the main harness, main switch lead, handlebar switch lead (left) and clutch cable through the guide.
- L** Install the clamp to the center cowl.
- M** Insert the clamp to the frame.
- N** Install the wire harness, taking care to ensure that the wire harness is not jammed up hard against the bolt of the damping gas compartment.

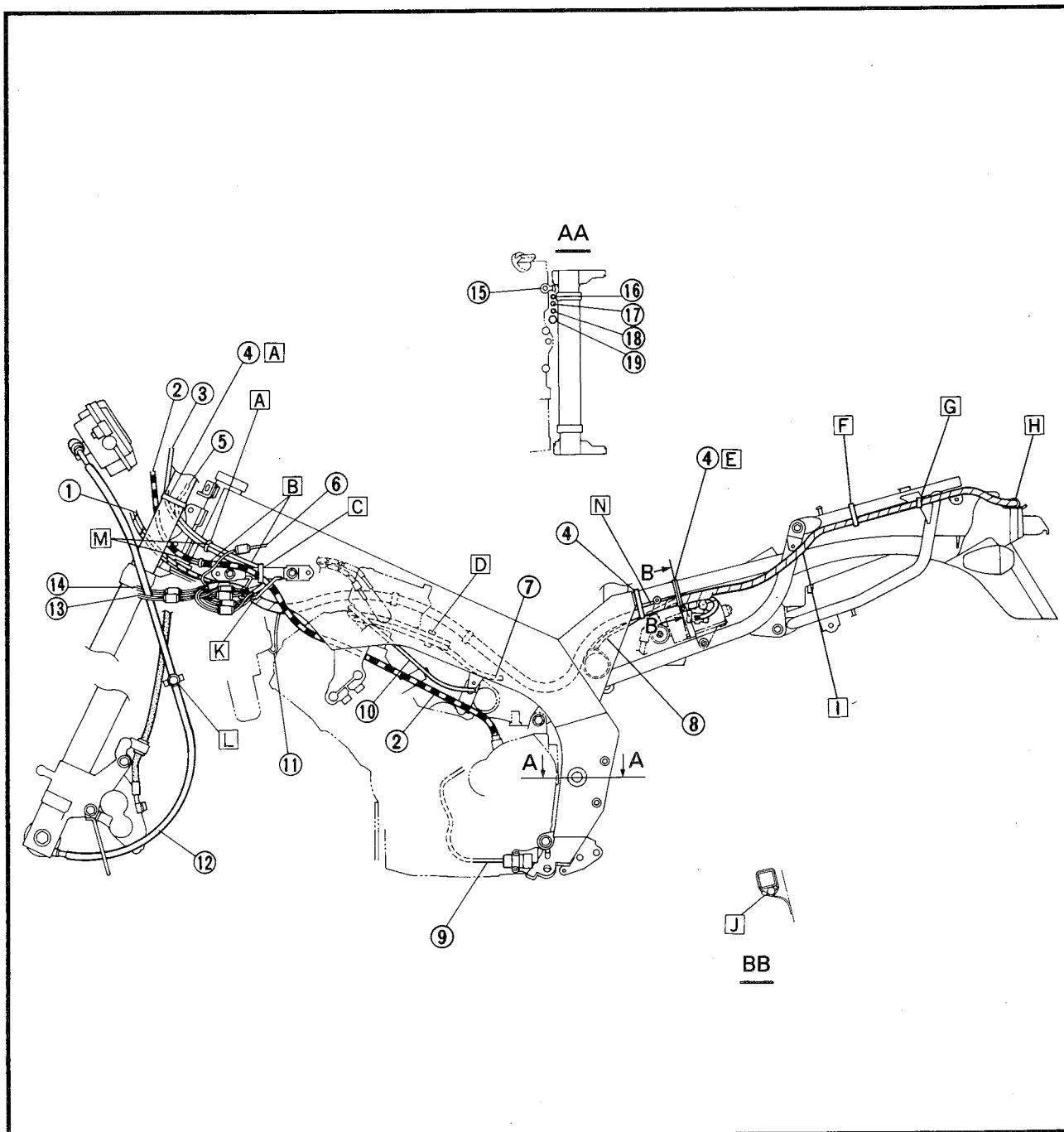

EXPLODED DIAGRAM

FRONT FORK

- ① Cap bolt complete
- ② O-ring
- ③ Locknut
- ④ Spring seat
- ⑤ Fork spring
- ⑥ Damper rod assembly
- ⑦ Oil lock piece
- ⑧ Inner fork tube
- ⑨ Piston metal
- ⑩ Dust seal
- ⑪ Stopper ring
- ⑫ Oil seal
- ⑬ Seal spacer
- ⑭ Slide metal
- ⑮ Outer fork tube
- ⑯ Damper rod bolt

A	FORK OIL (EACH):
B	CAPACITY: 431 cm ³ (15.2 Imp oz, 14.6 US oz)
C	OIL LEVEL: 137 mm (5.40 in) From top of inner fork tube fully compression without spring
D	GRADE: Fork oil 10WT or equivalent

E	FORK SPRING FREE LENGTH: <LIMIT> 419.5 mm (16.52 in)
---	--

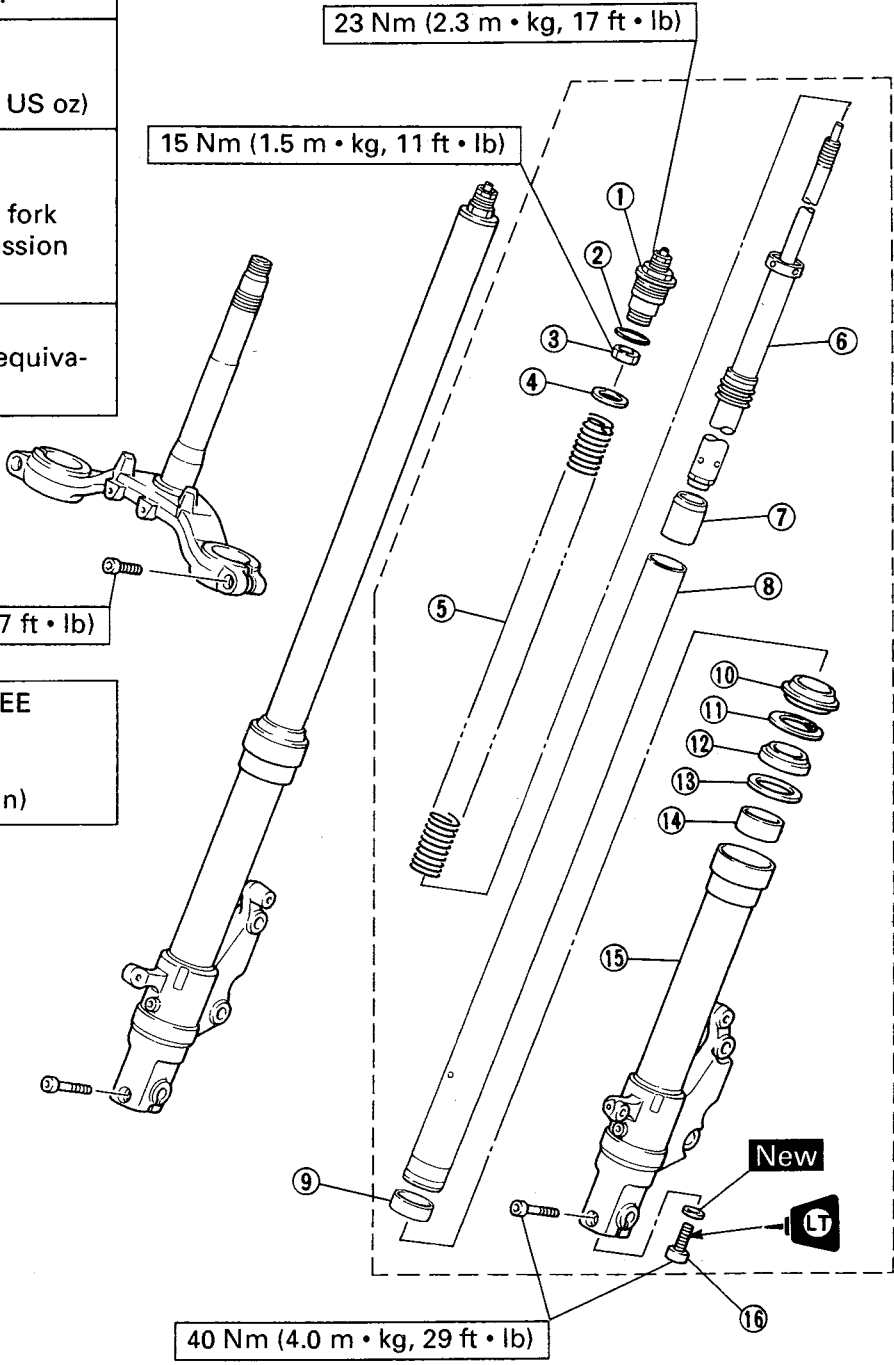

REAR SHOCK ABSORBER AND SWINGARM



REAR SHOCK ABSORBER AND SWINGARM

- ① Shock absorber
- ② Swingarm
- ③ Bearing
- ④ Thrust washer
- ⑤ Thrust cover
- ⑥ Collar
- ⑦ Relay arm
- ⑧ Connecting rod
- ⑨ Oil seal
- ⑩ Damping gas compartment

NOTE: Coat the bearings, bushings, thrust covers, oil seals, and collars with a liberal amount of molybdenum disulfide grease before installing. After installing, thoroughly wipe off excess grease.

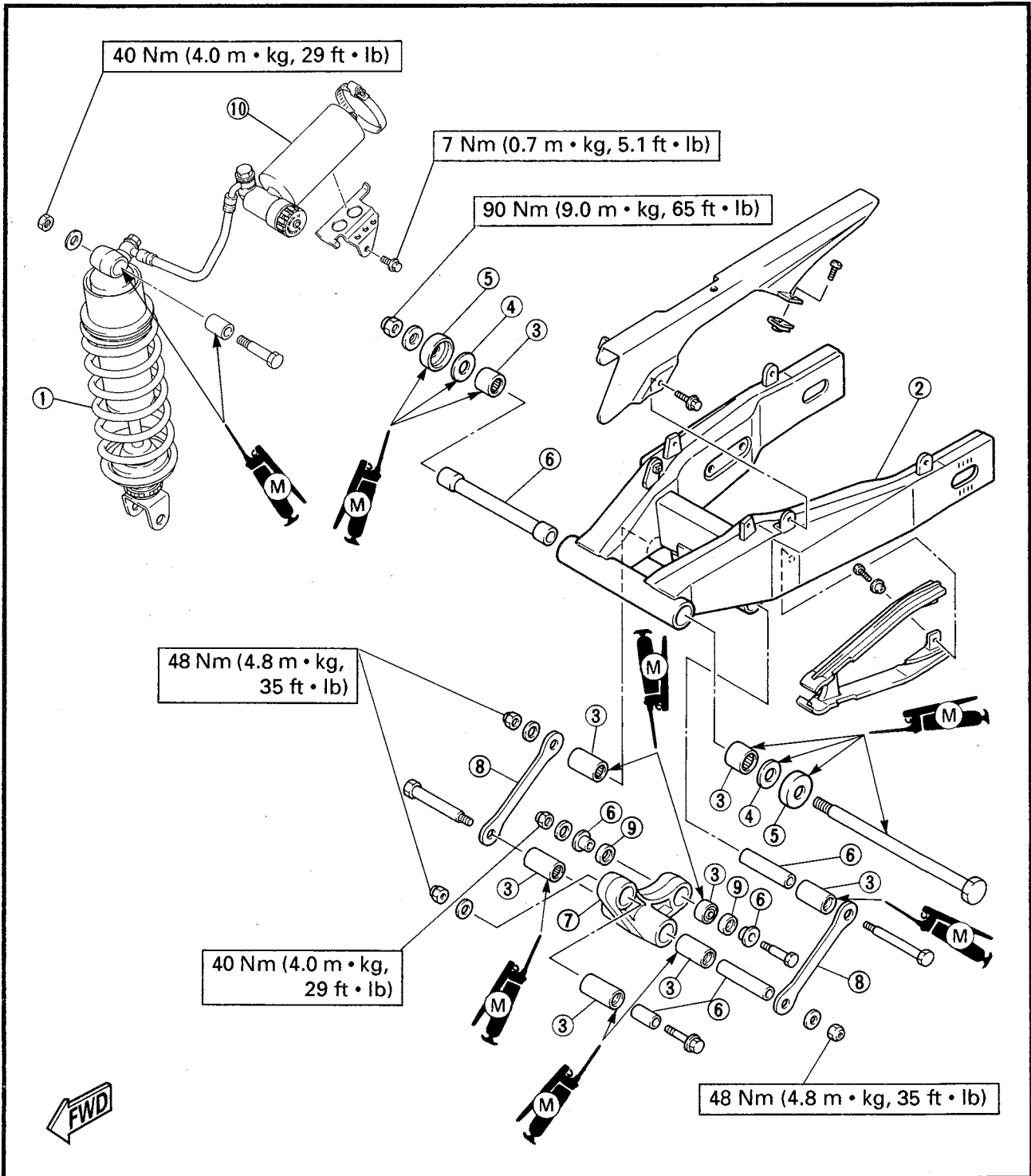

YAMAHA MOTOR CO.,LTD.

PRINTED ON RECYCLED PAPER

PRINTED IN JAPAN
94・9 - 1.1 × 1 CR
(英)